

Installation Instructions

Surface Fixed

Rainbow Trio Chimes
Pentatonic 6 Notes

Page 1 of 3



Components:

 M6 Saddle Straps
X2

 M6x20mm
Secure Screw
X4

 M8x40mm
Secure Screw
X4

Metric Conversion:
1260mm/ 49 39/64"
1.5m/ 59"

1. Lay both posts on a **non-abrasive level surface**. Line up the pre-drilled holes in the backboards with the holes in the legs. The **C5 chime vinyl tape strip goes on the left**. Fix in place using **M8x40mm screws** supplied (See installation guide).

2. Attach Surface Fixing plates to posts. (See Surface Fix Post Installation Sheet).

3. **Locate Instrument** in desired location and mark holes to fix to desired surface.

4. Fix Surface Plate to level surface using Coachscrews, Rawlbolts, chemical anchors or similar as deemed appropriate by installer.

5. Make sure all fixings are covered and secure using cover caps provided.

6. Beaters can be fixed to Steel posts with fixings provided.

Weight of heaviest part **8.35kg** (Freechimes)

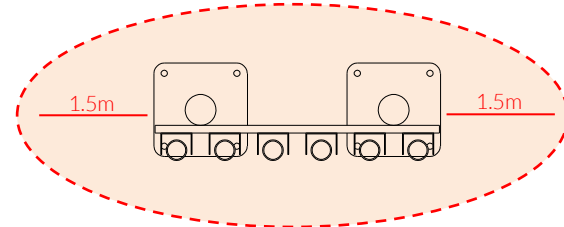

Install Instrument with 1.5m free space (from widest point) around it.

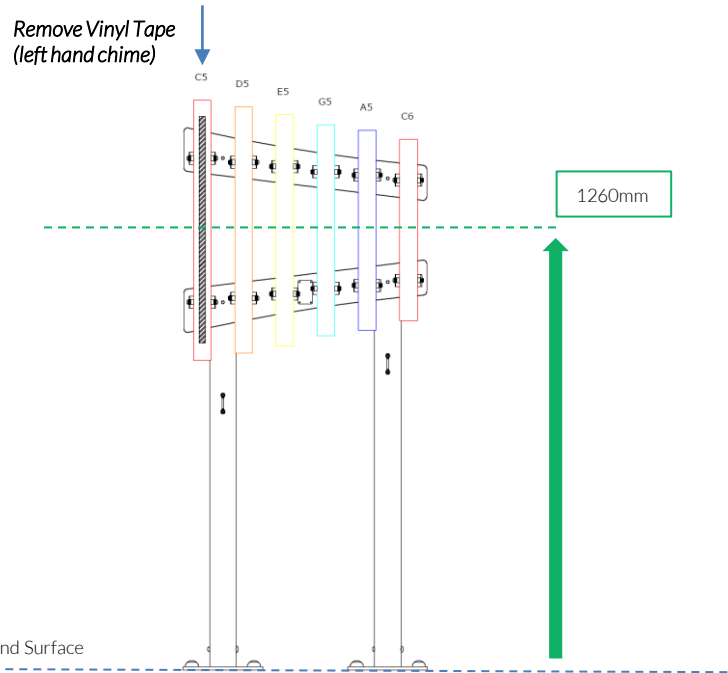

Pair Small
Beaters X1

Surface Fix
Components:

 x8

 x2

 x2



Spares available from
percussionplay.com or from your
local distributor

16 Kg

Tools:

TX 30 Driver Bit x1
TX 45 Driver Bit x2

Surface Fixed
Rainbow Trio Chimes
Pentatonic 6 Notes
Page 2 of 3



Components:

- M6 Saddle Straps X2
- M6x20mm Secure Screw X4
- M8x40mm Secure Screw X4

472mm Pentatonic 6 Note Post Centres

Thread Lock Solution Required (Not Supplied)

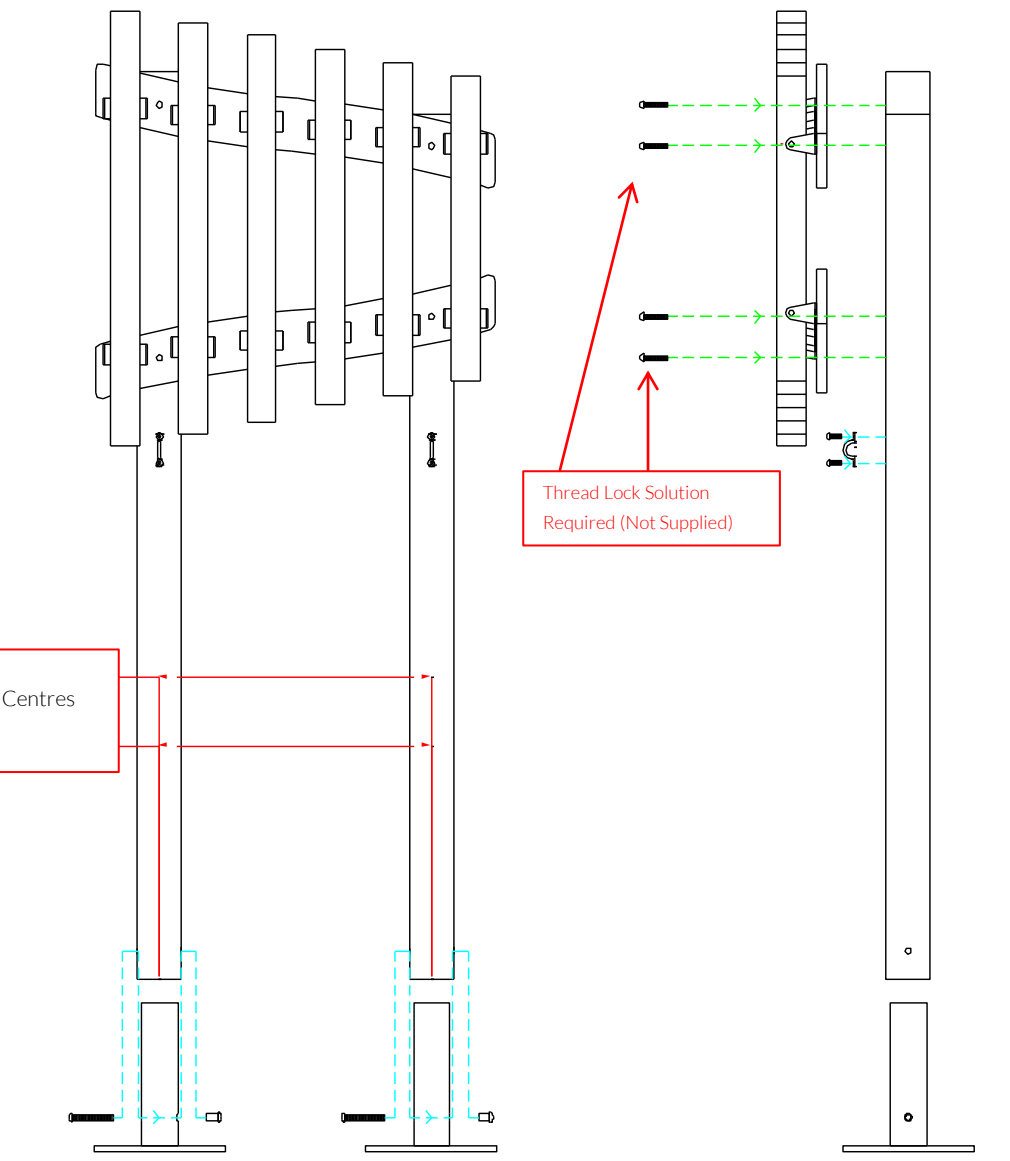

Thread Lock Solution Required (Not Supplied)

- COMPONENTS LIST:**
- Saddle Strap X2
 - M6x20 Pin torx X4
 - M8 X 40 Pin Torx X4
 - M10x70 Pin torx X2
 - M10 Barrel Nut Pin torx X2

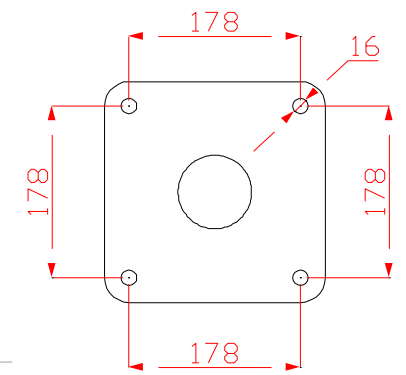

Pair Small Beaters X1

Surface Fix Components:

- 2 Part Cover Cap x8
- M10 Barrel Nut x2
- M10x70 Security Screw x2



Spares available from percussionplay.com or from your local distributor

16 Kg

Tools:

 x2
TX 45 Driver Bit

Surface Fixed
Rainbow Trio Chimes
Pentatonic 6 Notes
Page 3 of 3



Components:



x2

M10 Barrel Nut



x2

M10x70 Security Screw



x8

2 Part Cover Cap

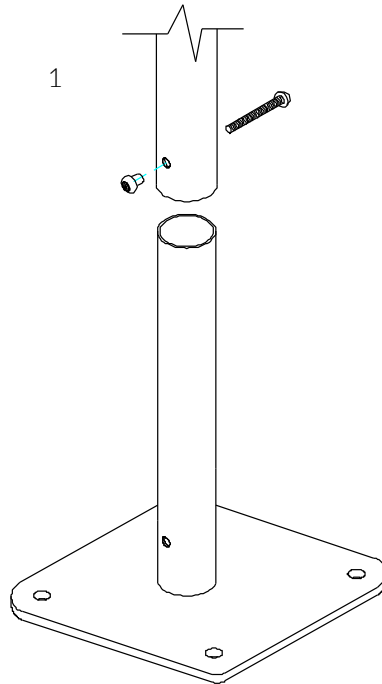

1
Locate the Surface fix Plate into the leg of the instrument.

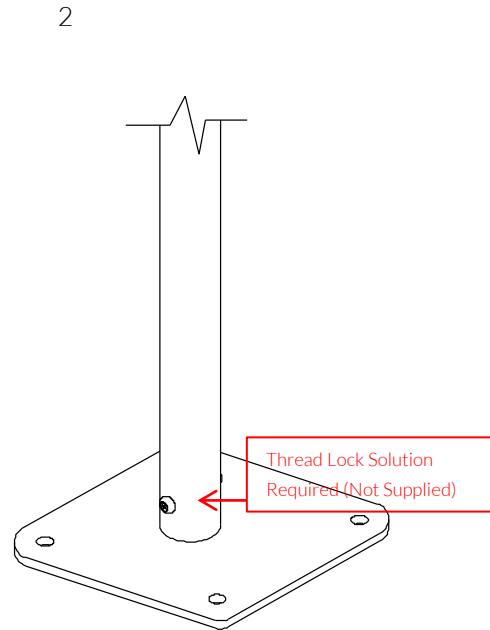

2
Fix instrument to Surface fix plate using M10 bolt and Barrel Nut and use **thread locking solution** to prevent fixings working loose.

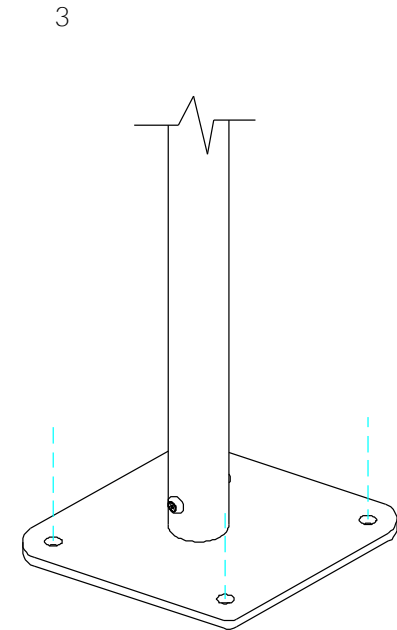

3
Fix Surface Plate to the ground surface **Ground Anchors Not provided** cover fixings with caps provided

Thread Lock Solution
Required (Not Supplied)



MADE IN BRITAIN

BSEN 1176

