

Installation Instructions

Ground Fixed Calypso Quatro Post Page 1 of 3



Instrument Components:

-  x8
-  x2
-  x4
-  x2

Metric Conversion:
250mm/ 10"
400mm/ 16"
450mm/ 18"
1510mm/ 59"
1.5m/ 59"



Weight of heaviest part 7.5kg



1. Instrument will arrive on site fully assembled. **(1.1)**
(See Assembly Guide)

2. Attach Ground Fixing studs holes in base of centre post. **(1.2)** **(See Ground Fix Post Installation Sheet)**

3. Excavate **1 hole** for the Steel legs **250mm diameter** by **450mm deep** in desired location upon decision from customer.

4. Locate (lower) leg into hole, making sure it is vertical and level prior to concreting in place.

5. Once happy with location of the Instrument, **fill holes using rapid hardening concrete**. Be sure to compact concrete around legs and leave to dry according to manufacturers guidelines.

6. Attach the 1 pair of beater to the saddle strap on each side of the post. **(1.3)**

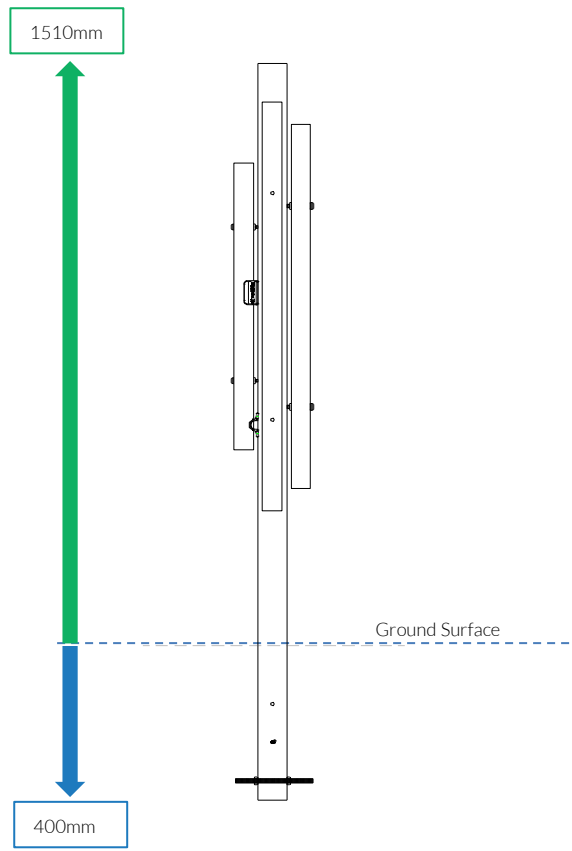
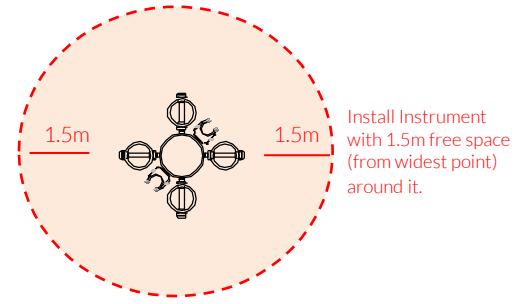

Ground Fix Components:

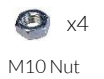

Spares available from percussionplay.com or from your local distributor

12 Kg

Tools:
 x1
 TX 30 Driver Bit

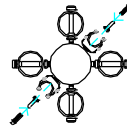

Ground Fixed Calypso Quatro Post Page 2 of 3



Instrument Components:

-  x8
M6x20 Security Screw
-  x2
M6 Saddle Strap
-  x4
M6 Square Nut
-  x2
Beater Holder

Thread Lock Solution
 Required (Not Supplied)

Thread Lock Solution
 Required (Not Supplied)

COMPONENTS LIST:

-  M10 Nut X4
-  M10x200 Threaded Bar X2
-  Saddle Strap X2
-  M6x20 Pin torx X8
-  M6 Square Nut X2
-  Beater Holder X2

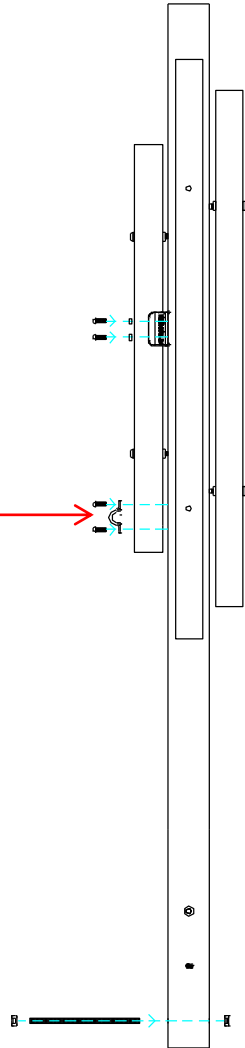

Ground Fix
 Components:



Spares available from
percussionplay.com or from your
 local distributor

12 Kg

Ground Fixed
Calypso Quatro Post
Page 3 of 3

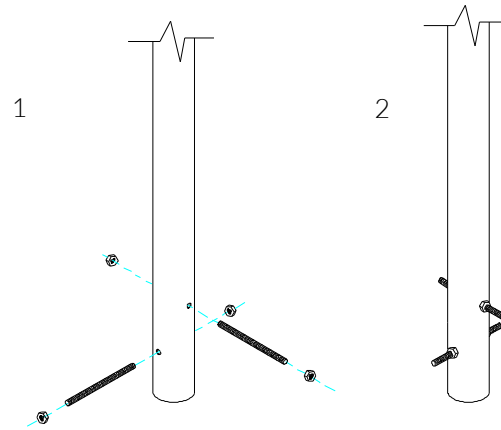

Fix M10x 200 Threaded bar
in place using M10 Nuts

Components:



x2

M10x200
Threaded Bar



x4

M10 Nut

Metric Conversion:

- 50mm/ 2"
- 250mm/ 10"
- 350mm/ 14"
- 400mm/ 16"
- 450mm/ 18"

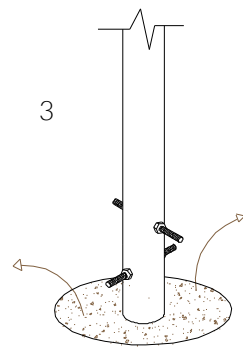

Excavate 1 holes with a
250mm diameter tapering
down to 350mm diameter
and 450mm depth

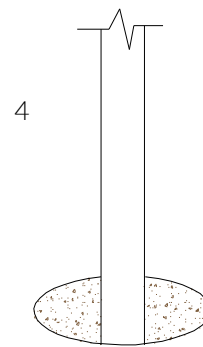

Compact base of hole with
50mm of aggregate.
Lower ground Fix post
attached to instrument
into hole (check
instrument straight and
level before filling with
concrete)

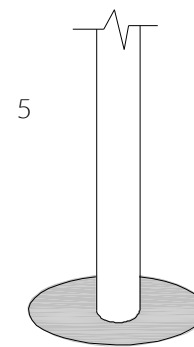

Fix hole with fast drying
concrete to manufacturers
specifications.

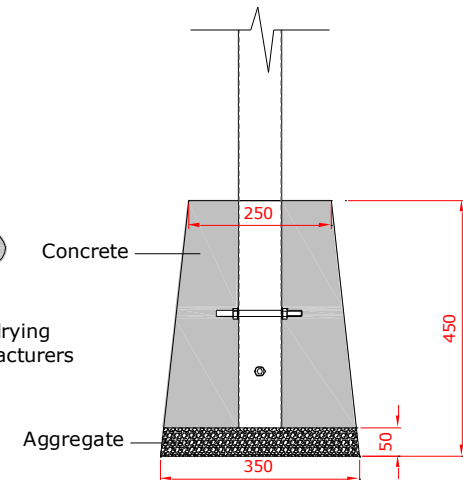

400mm min depth

